

SOLIDS INTERCEPTOR



Approval Date

Customer Approval

Job Location

Job Name

Dimensional Data (Inches/mm) are Subject to Manufacturers Tolerance and Change Without Notice. Wade Division / Tyler Pipe Assumes No Responsibility For Superseded or Voided Data

5740-L-XT

LARGE CAPACITY SOLIDS INTERCEPTOR WITH WHITE ACID RESISTANT COATING, REMOVABLE SEDIMENT BUCKET WITH TWO FLOW DIFFUSING FILTER ELEMENTS, INTEGRAL EXTENSION, 2" NPT THREADED INLET / OUTLET AND NON-SKID TREAD PLATE COVER. FLOW RATE = 30 GPM. MATERIAL: STEEL.

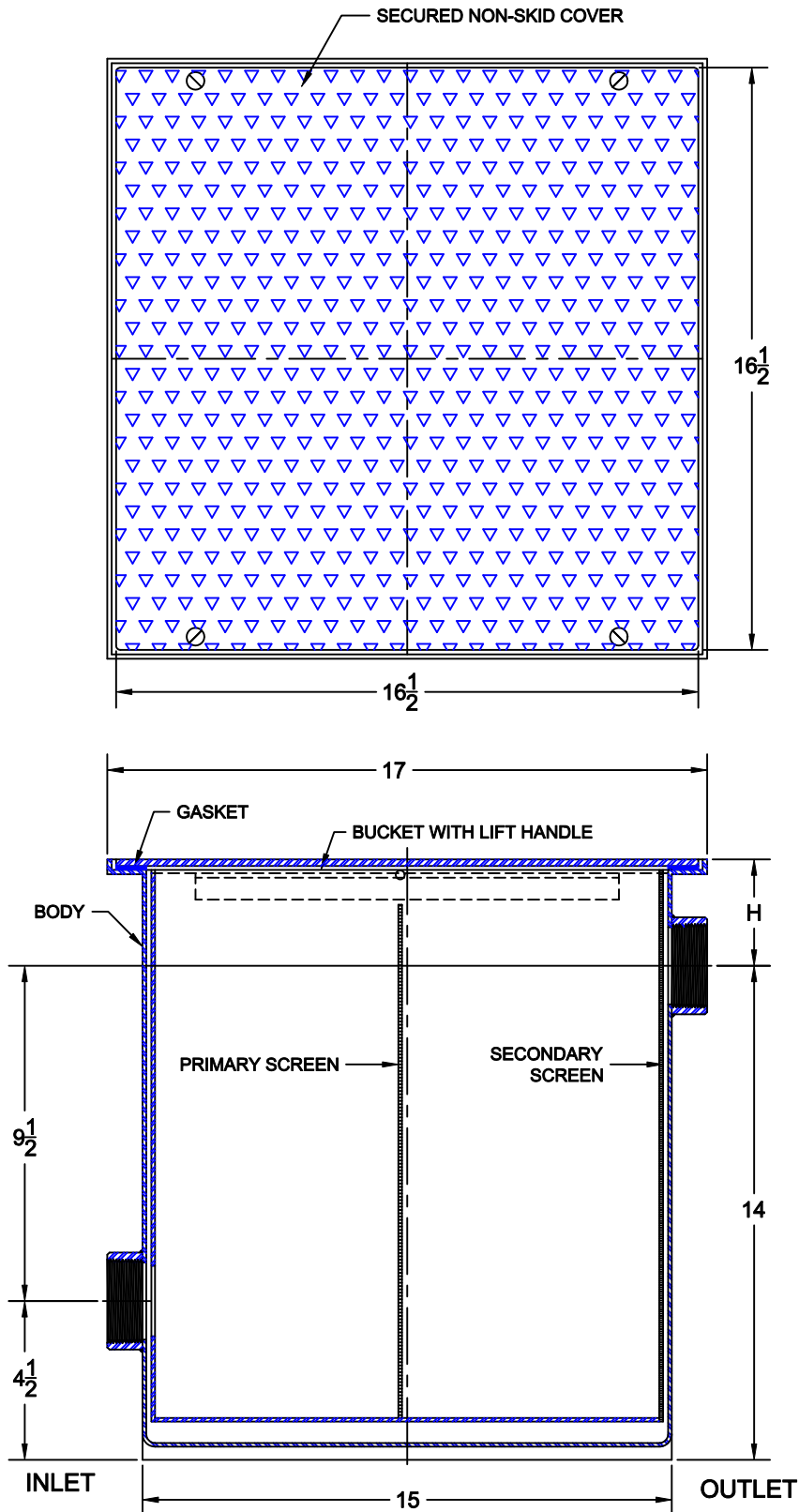

SPECIFY 'H' DIMENSION _____