

DOWNSPOUT NOZZEL

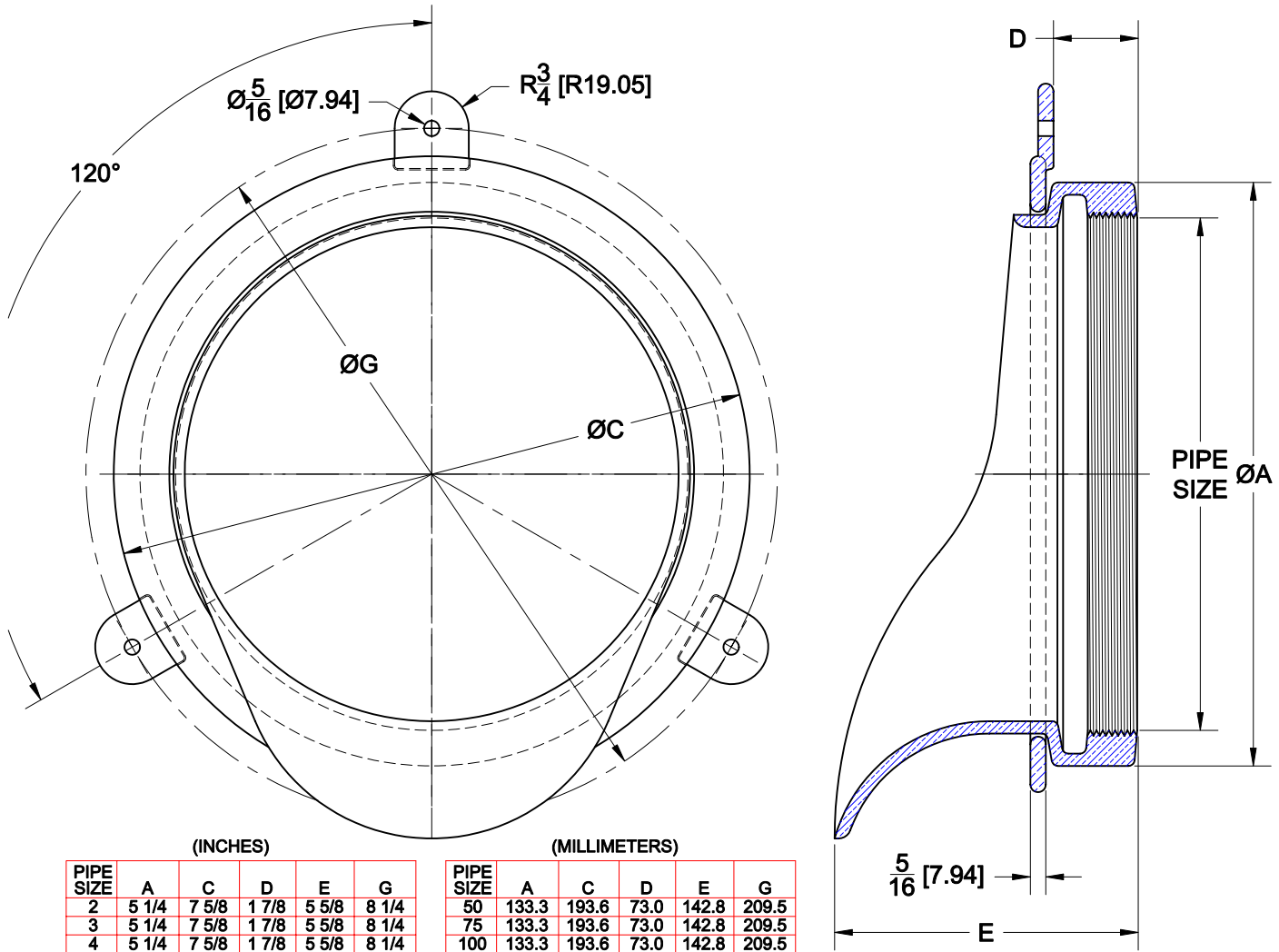

3940

CAST BRONZE DOWNSPOUT NOZZEL WITH THREADED OUTLET, AND ANCHOR FLANGE



(INCHES)					
PIPE SIZE	A	C	D	E	G
2	5 1/4	7 5/8	1 7/8	5 5/8	8 1/4
3	5 1/4	7 5/8	1 7/8	5 5/8	8 1/4
4	5 1/4	7 5/8	1 7/8	5 5/8	8 1/4
5	5 7/8	7 3/4	1	5 7/8	8 1/2
6	7	8 3/4	1	5 3/4	9 1/2
8	9 5/16	10 7/8	1 1/8	5 3/4	11 5/8
10	11 7/8	12 7/8	1 3/4	6 1/8	14

(MILLIMETERS)					
PIPE SIZE	A	C	D	E	G
50	133.3	193.6	73.0	142.8	209.5
75	133.3	193.6	73.0	142.8	209.5
100	133.3	193.6	73.0	142.8	209.5
125	149.2	196.8	25.4	149.2	215.9
150	177.8	222.2	25.4	146.0	241.3
200	236.5	276.2	28.5	146.0	295.2
250	301.6	327.0	44.4	155.5	355.6

			OPTIONS	
Cat. No.	Pipe Size	Wt. Lbs.	Suffix	Description
<input type="checkbox"/> 3942	2 (50)	10.5	<input type="checkbox"/> 1	NICKEL PLATED BODY & FLANGE
<input type="checkbox"/> 3943	3 (75)	9.5	<input type="checkbox"/> 2	SATIN FINISH ON BODY & ANCHOR FLANGE
<input type="checkbox"/> 3944	4 (100)	9.5	<input type="checkbox"/> 85	S/S PERFORATED BIRD SCREEN
<input type="checkbox"/> 3945	5 (125)	11.5	<input type="checkbox"/> 103	CHROME PLATED BODY & FLANGE
<input type="checkbox"/> 3946	6 (150)	13.5		
<input type="checkbox"/> 3948	8 (200)	15.5		
<input type="checkbox"/> 3949	10 (250)	19.5		

AutoCad.dwg